

SITE PLAN SHOWING LATITUDE & LONGITUDE FOR PROPOSED (G+XVIII) STORIED (60.0 M. HT.) RESIDENTIAL BUILDING AT PREMISES NO.- 42 A, HAZRA ROAD, KOLKATA- 700019, WARD NO.- 69, BOROUGH NO. - VIII, P.S.- BALLYGUNGE.

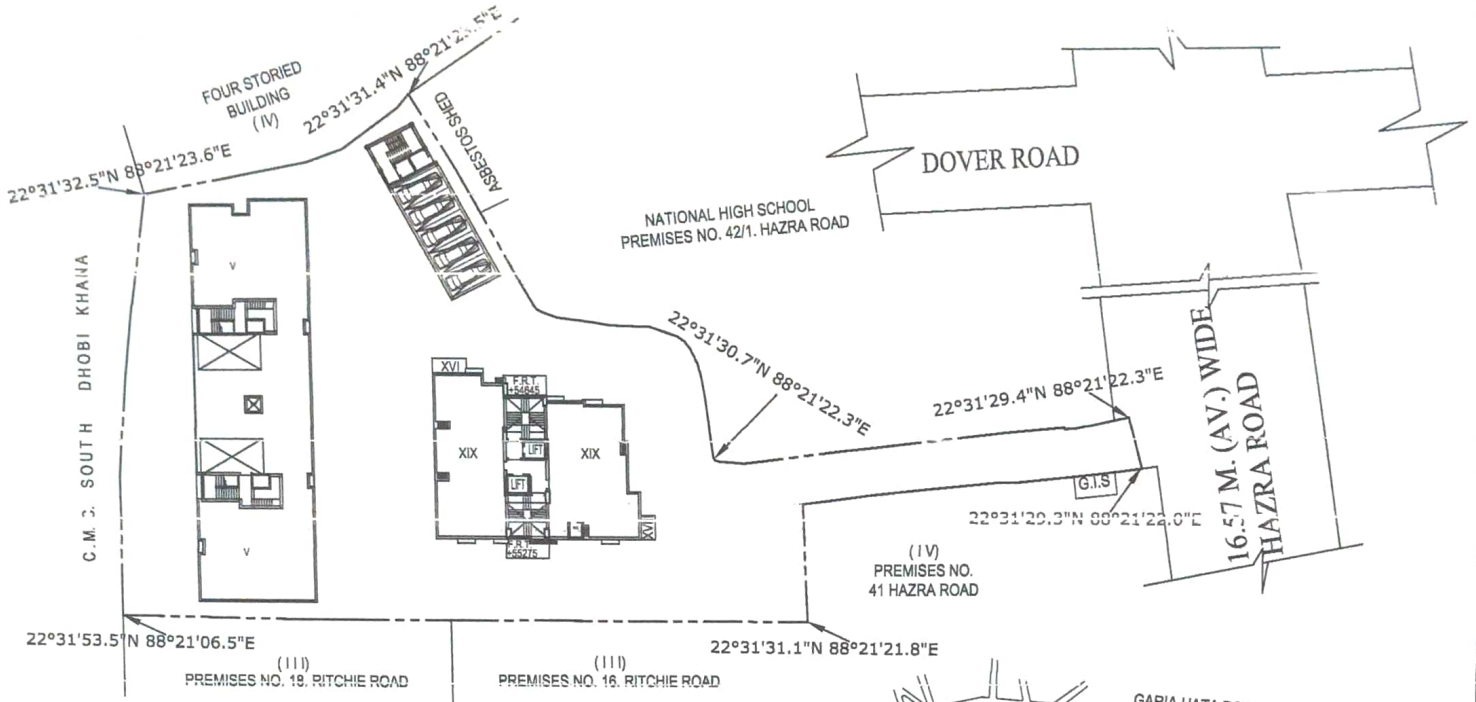

SITE PLAN
SCALE-1:600



LOCATION PLAN
SCALE-1:4000



For Swastic Projects Pvt. Ltd.

[Handwritten Signature]
Director